

## HDC 16B SBU 2M25G

**Weidmüller Interface GmbH & Co. KG**

Klingenbergstraße 26

D-32758 Detmold

Germany

[www.weidmueller.com](http://www.weidmueller.com)



The special die-cast alloy and the multi-layered surface sealing provide complete protection for the HDC housings.

The cleverly designed interlock system is manufactured from stainless steel. This guarantees a long lifespan with high resistance to corrosion and impact.

The housing interlock system provides integrated safety. Our unique, patented spring system provides the housing interlock with a secure grip and prevents accidental opening.

The laser marking allows for easy and quick identification. Each housing is permanently labelled with a laser marking so that each product can be quickly designated and positioned.

Weidmüller RockStar® IP 65 / NEMA Type 4X housings - your first choice for industrial housings with IP 65 protection.

### General ordering data

|            |  |
|------------|--|
| Version    | HDC enclosures, Size: 6, Protection degree: IP65 (in plugged condition), Base housing, Side-locking clamp on lower side, Standard, Size of cable entries: M 25 |
| Order No.  | <a href="#">1788240000</a>   |
| Type       | HDC 16B SBU 2M25G  |
| GTIN (EAN) | 4032248205776  |
| Qty.       | 1 pc(s).   |

## HDC 16B SBU 2M25G

**Weidmüller Interface GmbH & Co. KG**

Klingenbergstraße 26

D-32758 Detmold

Germany

www.weidmueller.com

## Technical data

### Dimensions and weights

|                             |         |                            |            |
|-----------------------------|---------|----------------------------|------------|
| Height                      | 64 mm   | Height (inches)            | 2.52 inch  |
| Width                       | 56.5 mm | Width (inches)             | 2.224 inch |
| Mounting dimension - height | 45 mm   | Mounting dimension - width | 105 mm     |
| Net weight                  | 357.8 g |                            |            |

### Temperatures

|                   |                   |
|-------------------|-------------------|
| Limit temperature | -40 °C ... 125 °C |
|-------------------|-------------------|

### Dimensions

|                      |           |                      |         |
|----------------------|-----------|----------------------|---------|
| Cable entry          | w. thread | Height of base B1    | 5 mm    |
| Height of housing B  | 64 mm     | Hole pitch length A2 | 105 mm  |
| Total length housing | 93.3 mm   | Width base C1        | 56.5 mm |
| Width housing C      | 43 mm     |                      |         |

### General data

|                             |                             |                       |                             |
|-----------------------------|-----------------------------|-----------------------|-----------------------------|
| EMC housings                | No                          | Housing main material | diecast aluminium           |
| Material of locking element | Stainless steel, rust-proof | Protection degree     | IP65 (in plugged condition) |
| Surface finish              | Powder coating              |                       |                             |

### Version

|                              |                                  |                                |              |
|------------------------------|----------------------------------|--------------------------------|--------------|
| BG                           | 6                                | Cable entry                    | w. thread    |
| Clamp version                | Side-locking clamp               | Colour (RAL)                   | RAL 7035     |
| Design                       | Standard                         | Design of housing              | Base housing |
| Design of locking system     | Side-locking clamp on lower side | Internal thread                | M 25         |
| Number of cable entry on top | 0                                | Number of cable entry sideways | 2            |
| Sealing                      | NBR                              | Size                           | 6            |
| Size of cable entries        | M 25                             | Suitable for ModuPlug®         | No           |
| Top part/bottom part/lid     | lower part                       | Type                           | Base housing |

### Classifications

|             |             |             |             |
|-------------|-------------|-------------|-------------|
| ETIM 6.0    | EC000437    | ETIM 7.0    | EC000437    |
| ETIM 8.0    | EC000437    | ETIM 9.0    | EC000437    |
| ECLASS 9.0  | 27-44-02-02 | ECLASS 9.1  | 27-44-02-02 |
| ECLASS 10.0 | 27-44-02-02 | ECLASS 11.0 | 27-44-02-02 |
| ECLASS 12.0 | 27-44-02-02 | ECLASS 13.0 | 27440202    |

|                     |                         |
|---------------------|-------------------------|
| Substance           | Acetone                 |
| Chemical resistance | Conditionally resistant |
| Substance           | Drilling oil            |
| Chemical resistance | Resistant               |
| Substance           | Diesel                  |
| Chemical resistance | Resistant               |
| Substance           | Ethyl alcohol           |
| Chemical resistance | Resistant               |

Creation date December 4, 2023 10:08:32 AM CET

Catalogue status 24.11.2023 / We reserve the right to make technical changes.

**HDC 16B SBU 2M25G**

**Weidmüller Interface GmbH & Co. KG**  
 Klingenbergstraße 26  
 D-32758 Detmold  
 Germany

www.weidmueller.com

**Technical data**

|                     |                         |
|---------------------|-------------------------|
| Substance           | Transmission oil        |
| Chemical resistance | Resistant               |
| Substance           | Hydraulic oil           |
| Chemical resistance | Resistant               |
| Substance           | Coolant                 |
| Chemical resistance | Resistant               |
| Substance           | Petroleum benzine       |
| Chemical resistance | Resistant               |
| Substance           | Sweat                   |
| Chemical resistance | Resistant               |
| Substance           | Premium gasoline        |
| Chemical resistance | Conditionally resistant |
| Substance           | Water                   |
| Chemical resistance | Resistant               |
| Substance           | UV                      |
| Chemical resistance | Unstable                |
| Substance           | Ozone                   |
| Chemical resistance | Unstable                |

**Environmental Product Compliance**

|                     |   |
|---------------------|---|
| REACH SVHC          | Lead 7439-92-1 Potassium perfluorobutane sulfonate 29420-49-3   |
| SCIP                | e98b2b24-ba23-41bf-8d19-0dda3647412f  |
| Chemical resistance | de.myview.objectmodel.impl.BlockImpl@2356eadd de.myview.objectmodel.impl.BlockImpl@29c0e424 de.myview.objectmodel.impl.BlockImpl@31e7e6a8 de.myview.objectmodel.impl.BlockImpl@4d4fdde4 de.myview.objectmodel.impl.BlockImpl@595bc692 de.myview.objectmodel.impl.BlockImpl@7714f859 de.myview.objectmodel.impl.BlockImpl@79c882b5 de.myview.objectmodel.impl.BlockImpl@4adbd095 de.myview.objectmodel.impl.BlockImpl@4db3f00a de.myview.objectmodel.impl.BlockImpl@1db50fd5 de.myview.objectmodel.impl.BlockImpl@2055fbfc de.myview.objectmodel.impl.BlockImpl@341ed81b de.myview.objectmodel.impl.BlockImpl@667f4d32 |

**Approvals**

Approvals



|                         |            |
|-------------------------|------------|
| ROHS                    | Conform    |
| UL File Number Search   | UL Website |
| Certificate No. (cURus) | E92202     |

**HDC 16B SBU 2M25G****Weidmüller Interface GmbH & Co. KG**

Klingenbergstraße 26

D-32758 Detmold

Germany

[www.weidmueller.com](http://www.weidmueller.com)**Technical data****Downloads**

---

|   |  |
|---|--|
| Approval/Certificate/Document of Conformity | <a href="#">Manufacturer's declaration</a>   |
| Engineering Data                            | <a href="#">CAD data – STEP</a>  |
| Product Change Notification                 | <a href="#">20220214 Technical change to HDC housings</a><br><a href="#">20220214 Technische Änderung bei HDC-Gehäusen</a> |
| Technical Documentation                     | <a href="#">1788240000 HDC 16B SBU 2M25G STP Blatt 1.pdf</a>   |
| Catalogues                                  | <a href="#">Catalogues in PDF-format</a>   |
| Brochures                                   | <a href="#">FL FIELDWIRING EN</a><br><a href="#">FL FIELDWIRING EN</a>   |

---

**HDC 16B SBU 2M25G**

**Weidmüller Interface GmbH & Co. KG**  
Klingenbergstraße 26  
D-32758 Detmold  
Germany

[www.weidmueller.com](http://www.weidmueller.com)

**Drawings**

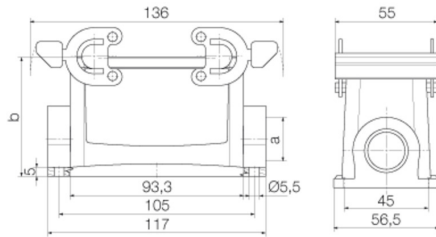

## HDC 16B SBU 2M25G

**Weidmüller Interface GmbH & Co. KG**  
Klingenbergstraße 26  
D-32758 Detmold  
Germany

www.weidmueller.com

## Accessories

### Hood, Cable Entry sideways



The special die-cast alloy and the multi-layered surface sealing provide complete protection for the HDC housings.

The cleverly designed interlock system is manufactured from stainless steel. This guarantees a long lifespan with high resistance to corrosion and impact.

The housing interlock system provides integrated safety. Our unique, patented spring system provides the housing interlock with a secure grip and prevents accidental opening.

The laser marking allows for easy and quick identification. Each housing is permanently labelled with a laser marking so that each product can be quickly designated and positioned.

Weidmüller RockStar® IP 65 / NEMA Type 4X housings - your first choice for industrial housings with IP 65 protection.

### General ordering data

|            |                            |  |
|------------|----------------------------|--|
| Type       | HDC 16B TSBU 1PG2 1G       | Version  |
| Order No.  | <a href="#">1656480000</a> | HDC enclosures, Size: 6, Protection degree: IP65 (in plugged condition), Cable entry from side, Plug housing, Side-locking clamp on lower side, Standard, Size of cable entries: PG 21 |
| GTIN (EAN) | 4008190409494              |  |
| Qty.       | 1 pc(s).                   |  |
| Type       | HDC 40D TSBU 1M32G         | Version  |
| Order No.  | <a href="#">1787000000</a> | HDC enclosures, Size: 6, Protection degree: IP65 (in plugged condition), Cable entry from side, Plug housing, Side-locking clamp on lower side, high, Size of cable entries: M 32      |
| GTIN (EAN) | 4032248204243              |  |
| Qty.       | 1 pc(s).                   |  |
| Type       | HDC 40D TSBU 1M40G         | Version  |
| Order No.  | <a href="#">1904800000</a> | HDC enclosures, Size: 6, Protection degree: IP65 (in plugged condition), Cable entry from side, Plug housing, Side-locking clamp on lower side, high, Size of cable entries: M 40      |
| GTIN (EAN) | 4032248521852              |  |
| Qty.       | 1 pc(s).                   |  |
| Type       | HDC 40D TSBU 1PG2 1G       | Version  |
| Order No.  | <a href="#">1656520000</a> | HDC enclosures, Size: 6, Protection degree: IP65 (in plugged condition), Cable entry from side, Plug housing, Side-locking clamp on lower side, high, Size of cable entries: PG 21     |
| GTIN (EAN) | 4008190409531              |  |
| Qty.       | 1 pc(s).                   |  |
| Type       | HDC 40D TSBU 1PG29G        | Version  |
| Order No.  | <a href="#">1656540000</a> | HDC enclosures, Size: 6, Protection degree: IP65 (in plugged condition), Cable entry from side, Plug housing, Side-locking clamp on lower side, high, Size of cable entries: PG 29     |
| GTIN (EAN) | 4008190409555              |  |
| Qty.       | 1 pc(s).                   |  |
| Type       | HDC 16B TSBU 1M25G         | Version  |
| Order No.  | <a href="#">1788180000</a> | HDC enclosures, Size: 6, Protection degree: IP65 (in plugged condition), Cable entry from side, Plug housing, Side-locking clamp on lower side, Standard, Size of cable entries: M 25  |
| GTIN (EAN) | 4032248205714              |  |
| Qty.       | 1 pc(s).                   |  |
| Type       | HDC 40D TSBU 1M25G         | Version  |
| Order No.  | <a href="#">1787010000</a> | HDC enclosures, Size: 6, Protection degree: IP65 (in plugged condition), Cable entry from side, Plug housing, Side-locking clamp on lower side, high, Size of cable entries: M 25      |
| GTIN (EAN) | 4032248204250              |  |
| Qty.       | 1 pc(s).                   |  |
| Type       | HDC 16B TSBU 1M40G         | Version  |
| Order No.  | <a href="#">1809620000</a> | HDC enclosures, Size: 6, Protection degree: IP65 (in plugged condition), Cable entry from side, Plug housing, Side-locking clamp on lower side, Standard, Size of cable entries: M 40  |
| GTIN (EAN) | 4032248284979              |  |
| Qty.       | 1 pc(s).                   |  |

Creation date December 4, 2023 10:08:32 AM CET

Catalogue status 24.11.2023 / We reserve the right to make technical changes.

6

## HDC 16B SBU 2M25G

**Weidmüller Interface GmbH & Co. KG**  
 Klingenbergstraße 26  
 D-32758 Detmold  
 Germany

www.weidmueller.com

## Accessories

### Hood, Cable Entry at top



The special die-cast alloy and the multi-layered surface sealing provide complete protection for the HDC housings.

The cleverly designed interlock system is manufactured from stainless steel. This guarantees a long lifespan with high resistance to corrosion and impact.

The housing interlock system provides integrated safety. Our unique, patented spring system provides the housing interlock with a secure grip and prevents accidental opening.

The laser marking allows for easy and quick identification. Each housing is permanently labelled with a laser marking so that each product can be quickly designated and positioned.

Weidmüller RockStar® IP 65 / NEMA Type 4X housings - your first choice for industrial housings with IP 65 protection.

### General ordering data

|            |                            |  |
|------------|----------------------------|--|
| Type       | HDC 16B TOBU 1PG21G        | Version  |
| Order No.  | <a href="#">1656590000</a> | HDC enclosures, Size: 6, Protection degree: IP65 (in plugged condition), Cable entry from top, Plug housing, Side-locking clamp on lower side, Standard, Size of cable entries: PG 21  |
| GTIN (EAN) | 4008190409609              |  |
| Qty.       | 1 pc(s).                   |  |
| Type       | HDC 40D TOBU 1M32G         | Version  |
| Order No.  | <a href="#">1787060000</a> | HDC enclosures, Size: 6, Protection degree: IP65 (in plugged condition), Cable entry from top, Plug housing, Side-locking clamp on lower side, high, Size of cable entries: M 32       |
| GTIN (EAN) | 4032248204304              |  |
| Qty.       | 1 pc(s).                   |  |
| Type       | HDC 40D TOBU 1PG21G        | Version  |
| Order No.  | <a href="#">1656630000</a> | HDC enclosures, Size: 6, Protection degree: IP65 (in plugged condition), Cable entry from top, Plug housing, Side-locking clamp on lower side, high, Size of cable entries: PG 21      |
| GTIN (EAN) | 4008190409647              |  |
| Qty.       | 1 pc(s).                   |  |
| Type       | HDC 40D TOBU 1M25G         | Version  |
| Order No.  | <a href="#">1787070000</a> | HDC enclosures, Size: 6, Protection degree: IP65 (in plugged condition), Cable entry from top, Plug housing, Side-locking clamp on lower side, high, Size of cable entries: M 25       |
| GTIN (EAN) | 4032248204410              |  |
| Qty.       | 1 pc(s).                   |  |
| Type       | HDC 40D TOBU 2M25          | Version  |
| Order No.  | <a href="#">1208380000</a> | HDC enclosures, Size: 6, Protection degree: IP65, IP65 (in plugged condition), Cable entry from top, Plug housing, Side-locking clamp on lower side, high, Size of cable entries: M 25 |
| GTIN (EAN) | 4032248100248              |  |
| Qty.       | 1 pc(s).                   |  |
| Type       | HDC 16B TOBU 1M25G         | Version  |
| Order No.  | <a href="#">1788210000</a> | HDC enclosures, Size: 6, Protection degree: IP65 (in plugged condition), Cable entry from top, Plug housing, Side-locking clamp on lower side, Standard, Size of cable entries: M 25   |
| GTIN (EAN) | 4032248205745              |  |
| Qty.       | 1 pc(s).                   |  |
| Type       | HDC 40D TOBU 1PG29G        | Version  |
| Order No.  | <a href="#">1656650000</a> | HDC enclosures, Size: 6, Protection degree: IP65 (in plugged condition), Cable entry from top, Plug housing, Side-locking clamp on lower side, high, Size of cable entries: PG 29      |
| GTIN (EAN) | 4008190409661              |  |
| Qty.       | 1 pc(s).                   |  |

**HDC 16B SBU 2M25G**

**Weidmüller Interface GmbH & Co. KG**  
 Klingenbergstraße 26  
 D-32758 Detmold  
 Germany

www.weidmueller.com

**Accessories**

**Cover**



The special die-cast alloy and the multi-layered surface sealing provide complete protection for the HDC housings.

The cleverly designed interlock system is manufactured from stainless steel. This guarantees a long lifespan with high resistance to corrosion and impact.

The housing interlock system provides integrated safety. Our unique, patented spring system provides the housing interlock with a secure grip and prevents accidental opening.

The laser marking allows for easy and quick identification. Each housing is permanently labelled with a laser marking so that each product can be quickly designated and positioned.

Weidmüller RockStar® IP 65 / NEMA Type 4X housings - your first choice for industrial housings with IP 65 protection.

**General ordering data**

|            |                            |  |
|------------|----------------------------|--|
| Type       | HDC 16B DODQ 4B0           | Version  |
| Order No.  | <a href="#">1665260000</a> | HDC enclosures, Size: 6, Protection degree: IP65 (in plugged condition), Cover for lower part of housing, Side-locking clamp on lower side, Standard |
| GTIN (EAN) | 4008190421960              |  |
| Qty.       | 1 pc(s).                   |  |