

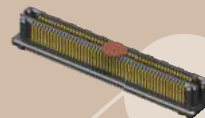

(0,50 mm) .0197"



LSHM-150-02.5-L-DV-A-N-K-TR



LSHM-120-04.0-L-DV-A-N-K-TR

LSHM-DV SERIES

HIGH SPEED HERMAPHRODITIC STRIP

SPECIFICATIONS

For complete specifications and recommended PCB layouts see www.samtec.com?LSHM-DV

Insulator Material: Black Liquid Crystal Polymer

Contact Material: Phosphor Bronze

Plating: Au or Sn over 50µ" (1,27 µm) Ni

Current Rating: 2.0 A per pin (2 adjacent pins powered)

Operating Temp Range: -55°C to +125°C

RoHS Compliant: Yes

Processing: Lead-Free Solderable: Yes

SMT Lead Coplanarity: (0,10 mm) .004" max

Board Stacking: For applications requiring more than two connectors per board, contact ipg@samtec.com

Board Mates: LSHM

Cable Mates: HLCD



High Speed/High Density

Optional shielding

Audible click when properly mated

Self-mating system can reduce inventory costs

Low cost Blade & Beam contact

Slim row-to-row design

Vertical orientation (Right angle available)

Mated height variety/flexibility

LSHM-DV/LSHM-DV 5 mm Stack Height	Rated @ 3dB Insertion Loss*
Single-Ended Signaling	11.5 GHz / 23 Gbps
Differential Pair Signaling	7 GHz / 14 Gbps

*Performance data includes effects of a non-optimized PCB. Performance data for other stack heights and complete test data available at www.samtec.com?LSHM-DV or contact sig@samtec.com

RECOGNITIONS

For complete scope of recognitions see www.samtec.com/quality



APPLICATION

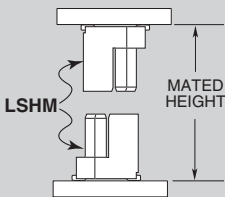

LEAD STYLE	MATED HEIGHT*
-02.5 & -02.5	(5,00) .196
-02.5 & -03.0	(5,50) .217
-03.0 & -03.0	(6,00) .236
-02.5 & -04.0	(6,50) .256
-03.0 & -04.0	(7,00) .276
-04.0 & -04.0	(8,00) .315
-02.5 & -06.0	(8,50) .335
-03.0 & -06.0	(9,00) .354
-04.0 & -06.0	(10,00) .394
-06.0 & -06.0	(12,00) .472

*Processing conditions will affect mated height.

Note: Some lengths, styles and options are non-standard, non-returnable.

LSHM - 1 NO. PINS PER ROW - LEAD STYLE - PLATING OPTION - TAIL OPTION - A - SHIELD OPTION - K - TR

20, 30, 40, 50

Specify LEAD STYLE from chart

-F = Gold flash on contact, Matte Tin on tail

-L = 10µ" (0,25 µm) Gold on contact, Matte Tin on tail

-DV = Vertical

-S = With Shield

-N = Without Shield

-K = (3,50 mm) .138" DIA Polyimide film Pick & Place Pad

-TR = Tape & Reel

LEAD STYLE (STANDARD)	LEAD STYLE (LUBRICATED)	A	B
-02.5	-L2.5	(3,95) .156	(1,00) .039
-03.0	-L3.0	(4,45) .175	(1,50) .059
-04.0	-L4.0	(5,45) .215	(2,50) .098
-06.0	-L6.0	(7,45) .293	(4,50) .177

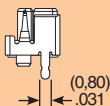
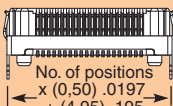
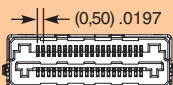

-DV-S

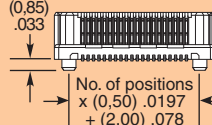
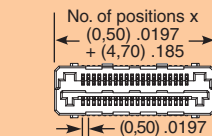

-DV-N

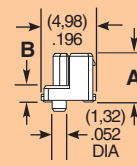

Due to technical progress, all designs, specifications and components are subject to change without notice.

WWW.SAMTEC.COM