

1

Pushbutton, opaque, mounting hole diameter 16.2 mm, 250 V/2 A



Technical data

General information

Form of lens protruding lens
 Colour of lens see order block
 Form of collar round

Dimensions

Diameter of collar 20 mm
 Overall height 9 mm
 Mounting depth 41 mm
 Mounting hole 16.2 mm

Mechanical design

Mounting ring nut
 Terminals screw terminals
 Contact system bridge contact
 Contact function momentary
 Contact arrangement see order block
 Contact materials Ag
 Illuminability no
 Lamp socket no

Mechanical characteristics

Operating force max. 7.5 N
 Operating travel 4.3 mm
 Switching travel NC 1.3 mm
 Switching travel NO 2.2 mm
 Robustness min. 100 N

Electrical characteristics

Rated voltage AC max. 250 V
 Rated current max. 2 A
 Contact resistance when new max. 100 mΩ

Other specifications

Operating life 150000
 Degree of protection from front side IP40 (IP65 with sealing cap)
 Ambient temp. operating min. -25 °C
 Ambient temp. operating max. +85 °C
 Storage temperature min. -40 °C
 Storage temperature max. +90 °C
 Resistance to constant environment according to IEC 600 68-2-3 and 2-30
 Resistance at variable environment according to IEC 600 68-2-14 and 2-33
 Weight 11 g
 Approvals ENEC 25 T 85
 Flame class acc. to UL 94 V 0
 Hot wire ignition acc. to IEC 60695-2-1 yes

Other Pushb.

Accessories Pushbutton, opaque, mounting hole diameter 16.2 mm, 250 V/2 A

Description	Photo	Order no.	Page
Sealing cap, black (IP65)		5.52.008.101/0100	
Sealing cap, red (IP65)		5.52.008.101/0300	
Protective sleeve for terminals		5.52.011.026/0100	
Protection against contact to VBG 4		5.55.101.715/0200	5 - 27

Accessories Pushbutton, opaque, mounting hole diameter 16.2 mm, 250 V/2 A

Description	Photo	Order no.	Page
Fixing spanner M 15, M 16		5.58.002.019/0105	5 - 23

Pushbutton, opaque, mounting hole diameter 16.2 mm, 250 V/2 A

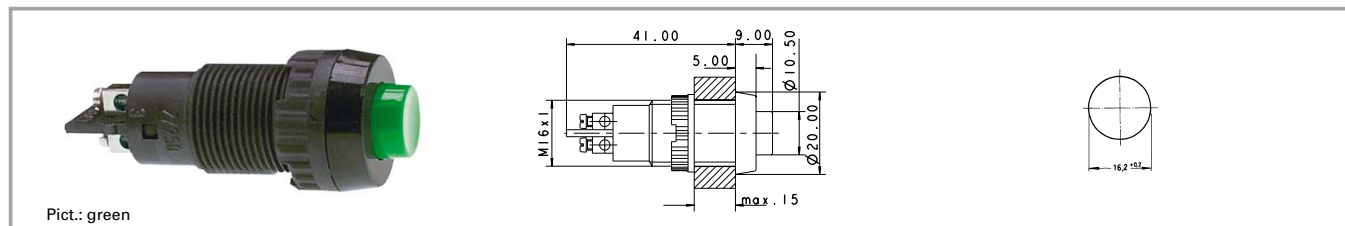

Contact arrangement	Contact function	Illuminability	Rated voltage AC max.	Colour of lens	Order no.
1 NO	momentary	no	250 V	opaque black	1.10.102.001/0104
1 NO	momentary	no	250 V	opaque white	1.10.102.001/0205
1 NO	momentary	no	250 V	opaque red	1.10.102.001/0301
1 NO	momentary	no	250 V	opaque green	1.10.102.001/0507
1 NC	momentary	no	250 V	opaque black	1.10.102.011/0104
1 NC	momentary	no	250 V	opaque red	1.10.102.011/0301

Technical data see page 1 - 80