

REV.	ECN NO.	DATE	SIGN	DESCRIPTION
A		2018/04/13	Brady	New Initial

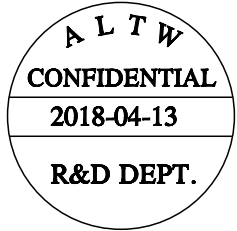
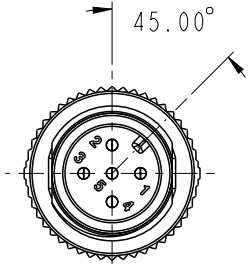
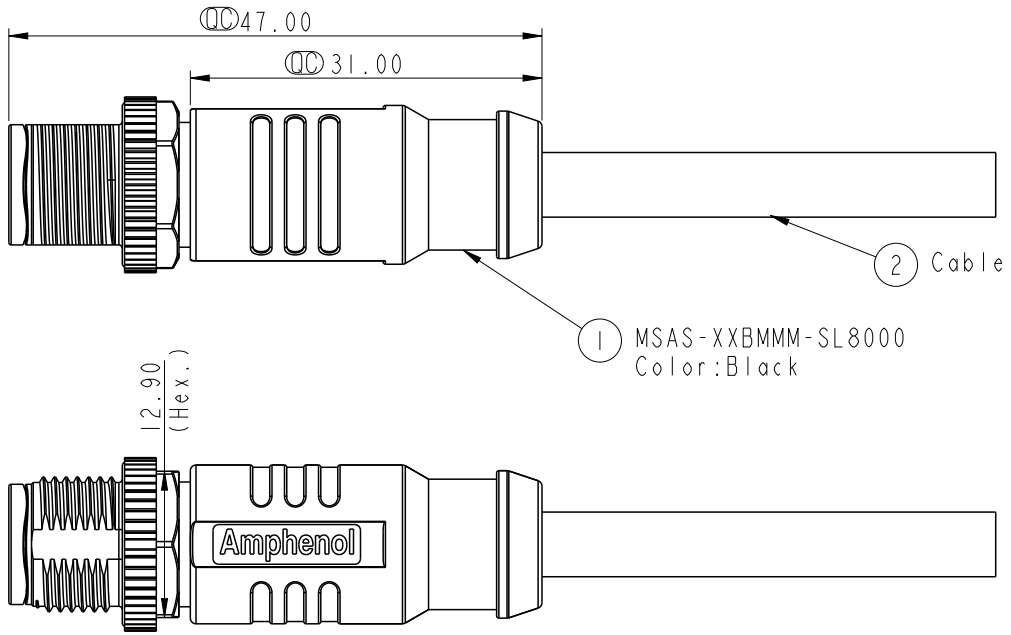

- Notes:
- * \varnothing Important Dimension.
 - * Waterproof Rate: IP68(Under water 1M for 24Hrs).
 - * Connector: Nylon+GF, Black.
 - * Male Pin: Copper Alloy, Gold Plated.
 - * Screw Nut: Zinc Alloy, Nickel Plated.
 - * Outer Mold: PP, Black.
 - * Cable: UL2517, Shield, PVC Jacket,UV resistant. Black.
UL20549,Shield, PU Jacket, Black.
 - * Rated Voltage: 3 & 4Pin 250V dc. or ac.
5Pin 60V dc. or ac.
6~12Pin 30V dc. or ac.
 - * Rated Current: 3~5Pin 4A
6~8Pin 2A
10~12Pin 1.5A
 - * Operating Temperature: -25~85°C

UNIT:mm		
TOLERANCE		
±0.5mm		

TITLE M12 Shielded A Code Cable Male Conn.			
SCALE 3:2	SIZE A4	SHEET 1 OF 3	
REV. A	WC-REV. A.1	\varnothing : Inspection item	

Amphenol LTW
安費諾亮泰企業股份有限公司

ITEM NO	DRAWN BY Brady	DATE 2018/04/13
DWG NO MSAS-XXBMMM-SL8XXX	CHECKED BY Neo	DATE 2018/04/13
CUSTOMER ALTW	APPROVED BY Max	DATE 2018/04/13

THIS DOCUMENT IS SUBJECT TO CHANGE WITHOUT NOTICE. IT IS CONFIDENTIAL AND A PROPERTY OF Amphenol LTW. DISCLOSURE TO THIRD PARTY HAS TO BE AUTHORIZED BY Amphenol LTW.

THIS DOCUMENT IS SUBJECT TO CHANGE WITHOUT NOTICE. IT IS CONFIDENTIAL AND A PROPERTY OF Amphenol LTW. DISCLOSURE TO THIRD PARTY HAS TO BE AUTHORIZED BY Amphenol LTW.

12P	PU	6.4	26	MSAS-12BMMM-SL8EXX
8P		5.8	24	MSAS-08BMMM-SL8EXX
5P		5.7	22	MSAS-05BMMM-SL8EXX
12P	PVC	6.4	26	MSAS-12BMMM-SL8DXX
8P		5.8	24	MSAS-08BMMM-SL8DXX
5P		5.7	22	MSAS-05BMMM-SL8DXX
Contacts	Cable Jacket	Cable OD	AWG	Item No.

M SAS - XX B M M M - S L 8 X XX

12A: A-Code Shielded

05: 5Pin
08: 8Pin
12: 12Pin

XX: 01~99Meters
01: 01Meter
02: 02Meters
:
99: 99Meters

D: PVC UL2517 Cable, Black (PVC 黑色外被線材)
E: PU UL20549 Cable, Black (PU 黑色外被線材)

8: IP68 (防水等級68)

L: Straight (180° 線端)

S: Screw (螺紋式)

M: Molding Type (射出成型)

B: Cable Without S/R (線端無網尾)

M: Male Connector (公座)

M: Male Pin (公Pin)

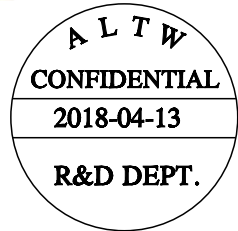

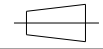
UNIT: mm  
TOLERANCE
±0.5mm

TITLE M12 Shielded A Code Cable Male Conn.			
SCALE 3:2	SIZE A4	SHEET 2 OF 3	
REV. A	WC-REV. A.1	QC: Inspection item	

Amphenol LTW
安費諾亮泰企業股份有限公司

ITEM NO	DRAWN BY Brady	DATE 2018/04/13
DWG NO MSAS-XXBMMM-SL8XXX	CHECKED BY Neo	DATE 2018/04/13
CUSTOMER ALTW	APPROVED BY Max	DATE 2018/04/13

THIS DOCUMENT IS SUBJECT TO CHANGE WITHOUT NOTICE. IT IS CONFIDENTIAL AND A PROPERTY OF Amphenol LTW. DISCLOSURE TO THIRD PARTY HAS TO BE AUTHORIZED BY Amphenol LTW.

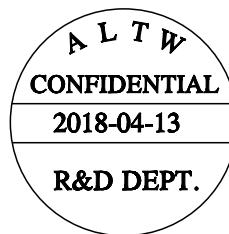

1	2	3	4	5	6	7	8
---	---	---	---	---	---	---	---

5 --	5 --	5 Gray	8 --	8 Red	12 --	12 Red/Blue	紅/藍
4 Black 黑	4 Black 黑	4 Black 黑	7 Blue 藍	7 Blue 藍	11 --	11 Gray/Pink 灰/粉	灰/粉
3 Blue 藍	3 Blue 藍	3 Blue 藍	6 Pink 粉	6 Pink 粉	10 Violet 紫	10 Violet 紫	紫
2 --	2 White 白	2 White 白	5 --	5 Gray 灰	9 Black 黑	9 Black 黑	黑
1 Brown 棕	1 Brown 棕	1 Brown 棕	4 Yellow 黃	4 Yellow 黃	8 Red 紅	8 Red 紅	紅
			3 Green 綠	3 Green 綠	7 Blue 藍	7 Blue 藍	藍
			2 Brown 棕	2 Brown 棕	6 Pink 粉	6 Pink 粉	粉
			1 White 白	1 White 白	5 Gray 灰	5 Gray 灰	灰
					4 Yellow 黃	4 Yellow 黃	黃
					3 Green 綠	3 Green 綠	綠
					2 Brown 棕	2 Brown 棕	棕
					1 White 白	1 White 白	白
Pin #	Wire	Wire	Wire	Wire	Wire	Wire	Wire

Pin Out

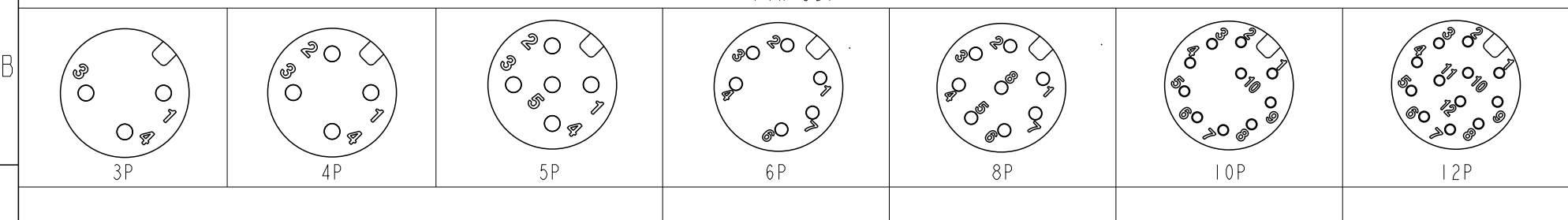

UNIT: mm			TITLE M12 Shielded A Code Cable Male Conn.	Amphenol LTW 安費諾亮泰企業股份有限公司	ITEM NO	DRAWN BY Brady	DATE 2018/04/13
TOLERANCE ±0.5mm			SCALE 3:2	SIZE A4	DWG NO MSAS-XXBMM-SL8XXX	CHECKED BY Neo	DATE 2018/04/13
			REV. A	WC-REV. A.1	CUSTOMER ALTW	APPROVED BY Max	DATE 2018/04/13
			SHEET 3 OF 3		④ Inspection item		

1	2	3	4	5	6	7	8
---	---	---	---	---	---	---	---