

**Features:**

- Universal AC input/ Full range
- Wide Operating Ambient Temperature (-20°C~60°C)
- High Efficiency, and High Reliability
- Ultra-minature size, low profile
- Output Protections: OLP/OVP/SCP
- All using 105°C long life electrolytic capacitors.
- 100% full load burn-in test



Model	QPS-20-5	QPS-20-12	QPS-20-15	QPS-20-24	QPS-20-48
Output Characteristics					
DC Output	5V	12V	15V	24V	48V
Rated Current	4A	1.67A	1.34A	0.84A	0.42A
Current Range	0~4A	0~1.67A	0~1.34A	0~0.84A	0~0.42A
Ripple and Noise	0~50°C	50mV	120mV	100mV	100mV
	-10~0°C	75mV	120mV	100mV	100mV
Voltage ADJ. Range	±10% of rated output voltage				
Voltage Accuracy	±2.0%	±2.0%	±2.0%	±2.0%	±2.0%
Line Regulation	±0.5%	±0.5%	±0.5%	±0.5%	±0.5%
Load Regulation	±2.0%	±2.0%	±2.0%	±2.0%	±2.0%
Set-up Time	<2.0s (115VAC input, full load); <1.0s (230VAC input, full load)				
Hold-up Time	>10ms (115VAC input, full load); >20ms (230VAC input, full load)				
Temperature Coefficient	±0.03%/°C				
Overshoot and Undershoot	<5.0%				
Input Characteristics					
Voltage Range	85VAC~264VAC				
Frequency Range	47Hz-63Hz				
Efficiency (Typical)	115VAC Input	72%	78%	80%	78%
	230VAC Input	72%	78%	80%	76%
AC Current (max)	0.5A	0.5A	0.5A	0.5A	0.5A
Inrush Current (Typical)	20A@115VAC Cold start 40A@230VAC Cold start				
Leakage Current	Input-Output: <0.35mA Input-PG: <0.75mA				
Protection					
Over Load (OLP)	105%~150% of rated output power, hiccup mode, auto recover				
Over Voltage (OVP)	110%~140% of rated output voltage, constant voltage				
Short Circuit (SCP)	Long-term mode, auto recovery				
Environmental Characteristics					
Operating Amb. Temp. & Hum	-20°C~60°C; 20%~90% RH Non-Condensing				
Storage Temp. & Hum	-40°C~85°C; 10%~95% RH Non-Condensing				
Safety Standards	UL60950-1; EN60950-1: 2006				
Withstand Voltage	Primary-Secondary: 3.0KVAC;≤10mA. Primary-PG: 1.5KVAC;≤10mA. Secondary-PG: 0.5KVDC;≤10mA				
Isolation Resistance	≥100M ohms				
EMI Conduction & Radiation	Compliance to EN55022(CISPR22) Class B				
Harmonic Current	Compliance to EN61000-3-2, 17625.1-2003				
EMS Immunity	Compliance to EN61000-4-2, 3, 4, 5, 6, 8, 11; ENV50204, light industry level, criteria A				
General Characteristics					
MTBF (MIL-HDBK-217F)	More than 100,000Hrs (25°C, Full load)				
Dimension (LxWxH)	89x51x20mm				
Packing	60PCS/CTN. G.W: 7.6kgs				
Cooling Method	Cooling by free air convection				

MECHANICAL SPECIFICATIONS

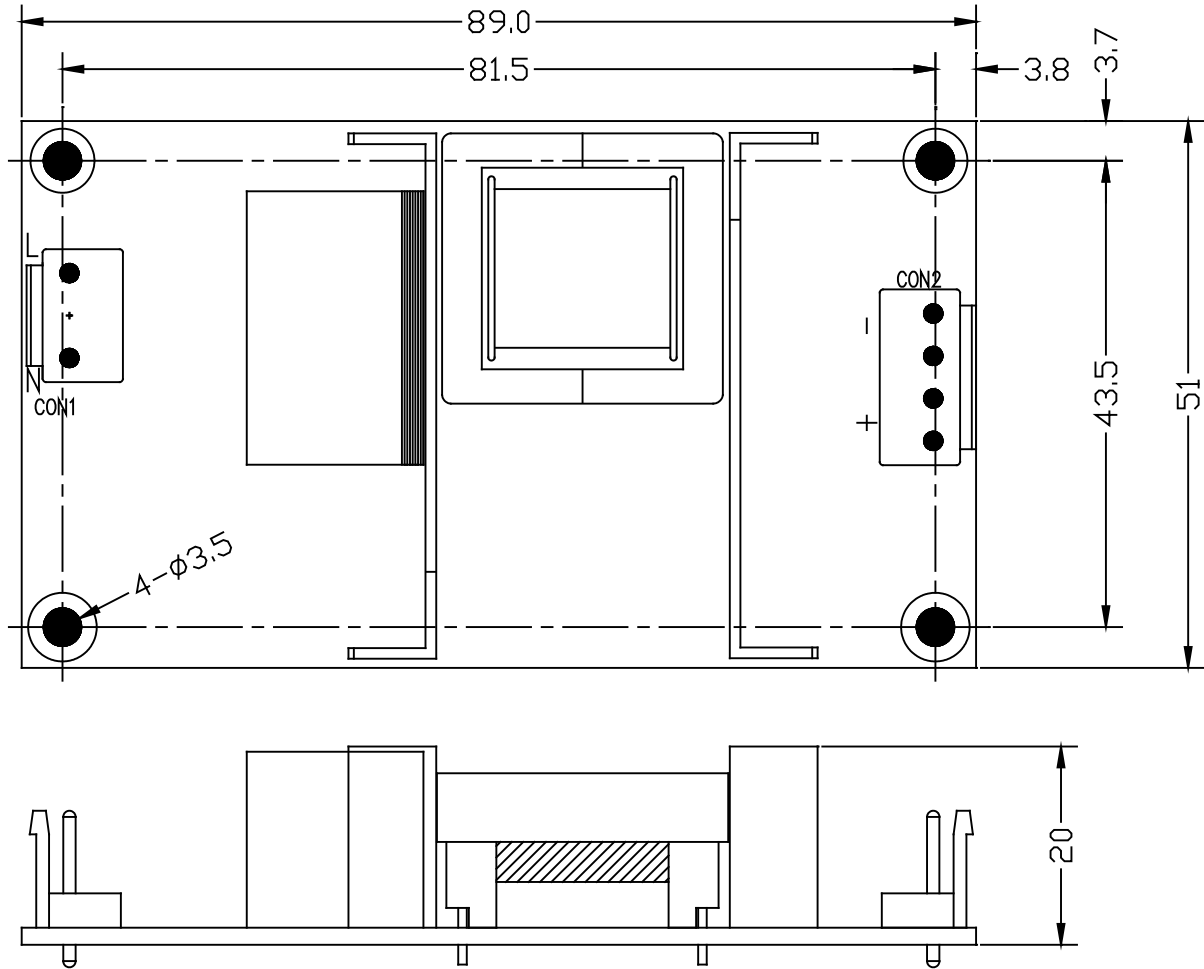

ITEM	CONNECTOR	MATING HOUSING	TERMINAL
AC IN (CON1)	LANDWIN 3961P0300T (CENTER PIN REMOVED)	LANDWIN 3960S OR JST VHR	LANDWIN 3963T011R OR JST SVH-21T-P1.1
DC OUT (CON2)	LANDWIN 3961P0400T		

UNIT: mm